

JK-1MD/JK-1MED

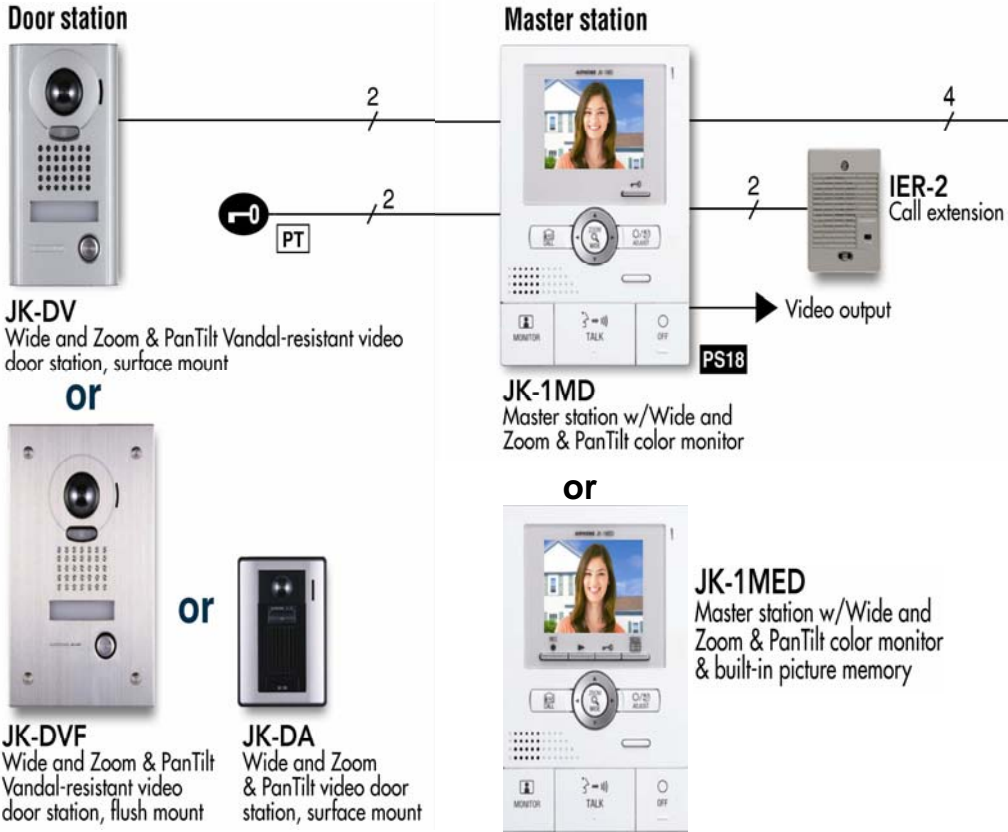

Wide and Zoom & PanTilt Hands-free Color Video Intercom



Zoom
To see the detail, switch the picture mode to Zoom mode. Switching between Wide and Zoom mode can be easily done by pressing a button.



PanTilt
Use the PAN/TILT button to change the camera angle in Zoom mode.

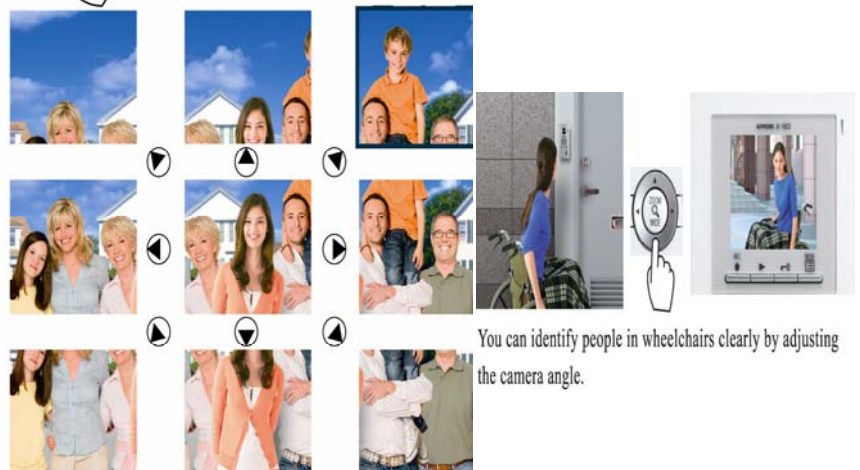

■ Preset the best camera angle!

You may find the default camera angle for receiving visitor images is not the best for your entrance condition. If so, you can adjust and reset the camera angle.

The visitor is not displayed in the center.

You can now clearly identify the visitor in the center of the monitor. This gives you flexibility when setting up the Door Station.



* Due to continuous product enhancement, Sin Chew Alarm reserves the right to change / modify specification without prior notice.

